

The logo for LENA LIGHTING, featuring a stylized square icon with a circle inside, followed by the text "LENA LIGHTING" in a bold, sans-serif font.

LENA
LIGHTING

STREETS & ROADS

Communication, light, road

Efficiency, safety and savings.
We present the latest proposal in lighting
roads, streets and parking lots.

TIARA LED

New generation
of road lighting

TIARA LED

Modern lamp for streets & roads



- Self-cleaning, uniform body
- High luminous efficacy <math><129\text{lm/W}</math>
- Wide range of precise light distribution
- Compatibility with modern control systems (optional connectors: NEMA and ZHA GA)
- LED lifetime: max 100.000h
- Rich, standard equipment: (NTC and 10kV protection, programmable DALI driver, tempered glass)



Uniform body structure housing minimizes risk of loss high IP66 protection.



Diffuser made of tempered glass, and effective matrices lenticular protection.



Quick, innovative assembly saves Installer's operational time.



Compatible with modern control systems (through the use of additional NEMA and ZHAGA connectors)

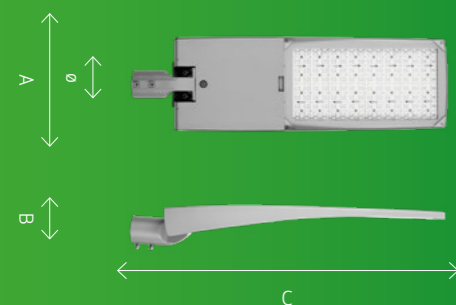

Street and road lighting must first ensure maximum comfort for users, while meeting the requirements of normative acts.

TIARA LED is a new generation of LED luminaires produced in Poland. The fitting has been improved to facilitate and accelerate installation: an independent body with an ergonomic suspension module for the light module. Application of dedicated optics enables to illuminate facilities such as: highways, express roads, national roads, municipal roads, urban roads, housing estate roads, area lighting, pedestrian crossings. In addition, optics are appropriate to illuminate sidewalks, bike paths, side streets.

- ➔ Power [W]: 17 - 217
- ➔ Luminous flux [lm]: 2000 - 28950
- ➔ Color temperature [K]: 3000, 4000, 5700
- ➔ Mounting: to the pole, on the arm
- ➔ Body: powder coated aluminum
- ➔ Diffuser: toughened glass,
- ➔ Impact resistance class: IK09
- ➔ Ingress protection class: IP66
- ➔ Energy efficiency class: A +
- ➔ Dimensions A / B / C / Ø [mm]: 665/122/262; 870/122/262
- ➔ Certificates: CE, ENEC (driver)



POLISH PRODUCTION
POLISH TECHNOLOGY

<math><129\text{lm/W}</math>

SDCM ≤ 3

A+



Scan the code and access the technical data sheet

Selected models of the luminaire:

| Luminaire power [W]: | Colour temperature [K] | Luminous flux [lm] | EEL | Index |
|----------------------|------------------------|--------------------|-----|--------|
| 18 | 4000 | 2450 | A+ | 955495 |
| 26 | 4000 | 3350 | A+ | 955501 |
| 36 | 4000 | 4900 | A+ | 955525 |
| 37 | 4000 | 4350 | A+ | 955518 |
| 52 | 4000 | 6600 | A+ | 955532 |
| 54 | 4000 | 7300 | A+ | 955556 |
| 57 | 3000 | 5900 | A+ | 955938 |
| 72 | 4000 | 9750 | A+ | 955587 |
| 76 | 4000 | 8950 | A+ | 955549 |
| 78 | 4000 | 9850 | A+ | 955563 |
| 90 | 4000 | 12100 | A+ | 955617 |
| 100 | 4000 | 12700 | A+ | 955594 |
| 108 | 4000 | 14600 | A+ | 955648 |
| 110 | 4000 | 12900 | A+ | 955570 |
| 125 | 4000 | 16900 | A+ | 955679 |
| 130 | 4000 | 16450 | A+ | 955624 |
| 140 | 4000 | 16750 | A+ | 955600 |
| 142 | 4000 | 19150 | A+ | 955693 |
| 155 | 4000 | 19950 | A+ | 955655 |
| 180 | 4000 | 22750 | A+ | 955686 |
| 184 | 4000 | 21450 | A+ | 955631 |
| 220 | 4000 | 25800 | A+ | 955662 |
| 228 | 4000 | 28950 | A+ | 955709 |

Luminaire parameters are given with tolerance permitted by the standard. The manufacturer reserves the right to change the parameters of the product not for the worse, in the course of its improvement, and to make design changes or upgrade the product. Materials presented in the booklet are not a commercial offer. The complete, current offer of Lena Lighting along with current parameters can be found at www.lenalighting.pl/en

STREETS AND ROADS



Communication,
light, road

Lena Lighting S.A.
ul. Kórnicka 52
63-000 Środa Wielkopolska
tel. +48 (61) 28 60 300
email: office@lenalighting.pl

www.lenalighting.pl/en